

KIMAFUN®



KIMAFUN Violin Microphone User Manual

KM-CX220 KM-CX220-1 KM-CX220-2 KM-CX220-3 KM-CX220-4

KM-CX220.....02-04

KM-CX220-1.....05-08

KM-CX220-2.....09-11

KM-CX220-3.....12-14





KM-CX220-4.....15-21

General Introduction

Thanks for choosing the KIMAFUN Violin Microphone, this product has wired and wireless version for your choice. This products is suitable for speakers, power amplifiers, mixers, mobile phones, laptops etc.

Please read the user manual carefully before use, so that you can operate correctly and exert the superior performance of this wireless microphone.

If you encounter any problems or any unpleasant experience in use, please contact us by email info@kimafun.com. We will process it for you as soon as possible. If you can attach pictures/videos related to the problem, we will deal with your problem more clearly and quickly.

Model	KM-CX220	KM-CX220-1	KM-CX220-2	KM-CX220-3	KM-CX220-4
Picture					
Wired/Wireless	Wired	2.4G Wireless	2.4G Wireless	2.4G Wireless	UHF Wireless
Wireless Distance	Wired with 3 meters	Wireless 15-50 meters (without visible obstacles)			
Power Supply	Small Button Battery	Built-in Lithium Battery			
Working Time	70-90 Hours	8-10 Hours	8-10 Hours	8-10 Hours	5-6 Hours
Mic Diameter	ϕ 6.0*2.7mm			ϕ 14.0*6.5mm	
Polar Patterns	Omnidirectional			Uni-directional	
Channels	No	One Channel	One Channel	One Channel	Six Channels
Compatible	Output Device: speakers, power amplifiers, mixers etc. Recording Device: mobile phones, laptops etc.				
Wide Application	Personal Exercises; Personal Music Performance Recording; Individual Performance				Stage Performance; Band Performances

KM-CX220 Package Included



Violin Microphone



Button Battery



6.35MM(1/4")
Adapter



User Manual



Splitter Cable



3M Extended
Cable



Windscreen
Foam



Carrying Bag

Main Features

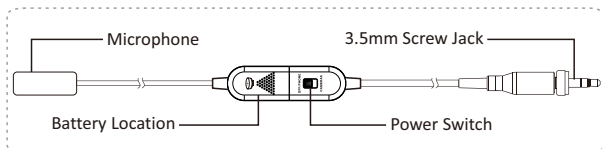

Specification

Mic Capsule: Condenser

Mic Diameter: $\phi 6.0 \times 2.7\text{mm}$

Polar Patterns: Omnidirectional

Sensitivity: $-42\text{dB} \pm 2\text{dB}$

Frequency Response: 20-20KHz

Output Impedance: $\leq 2.2\text{K}\Omega$

Working Voltage: 1.5V DC

Battery: LR626/1.5V

SNR: $> 63\text{dB}$

Wire Length: 0.8 Meter

Extended Cable: 3 Meters

Battery Installation

1. Please press the triangular projection on the battery cover and push it outward.
2. Expose the battery compartment.
3. Find the button battery in the carrying bag, keep the battery positive pole (+ symbol) upward and put it into the battery compartment.
4. Finally push the battery cover back.

Tip: Turn the switch to OFF/PHONE when the mic isn't using.

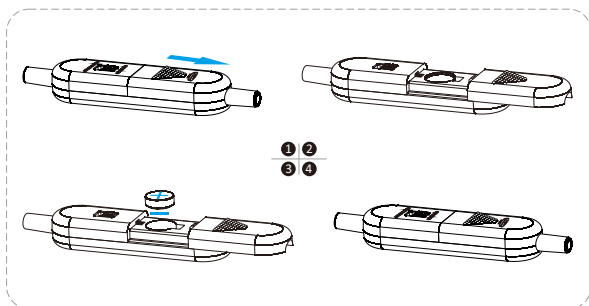

Microphone Installation

The microphone is clamped on the edge of the violin and fixed by rotating the lower handle, adjust the hose to make the wheat head reach the best pickup position.



Using Instruction

1.Used for speakers, power amplifiers, mixers etc.

Turn the switch to CAMERAS, the microphone in the power supply mode can be used for speakers, power amplifiers, mixers and other amplification equipment with a 6.35mm MIC Input socket.

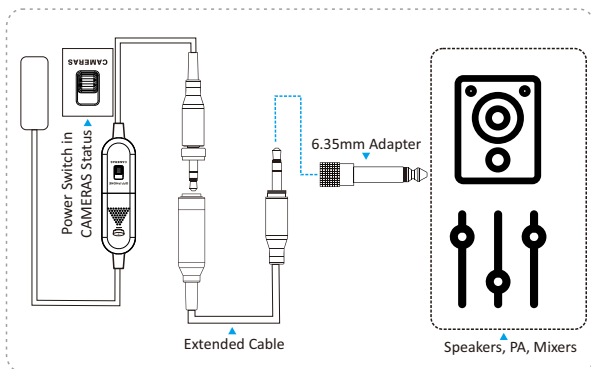

2.Used for Mobile Phones, Single-hole Laptops

Turn the switch to OFF/PHONE, the microphone not in the power supply mode can be used for mobile phones and single-hole laptops.

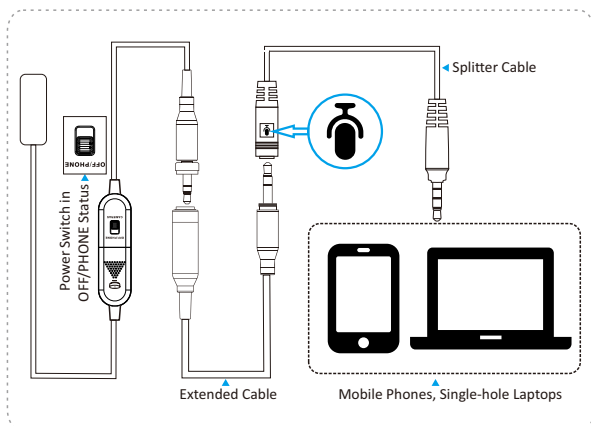

KM-CX220-1 Package Included



Violin Microphone



Transmitter



Receiver



Belt Clip



User Manual



Splitter
Cable



6.35MM(1/4")
Adapter



USB Charging
Cable



Windscreen
Foam



Carrying Bag

Main Features

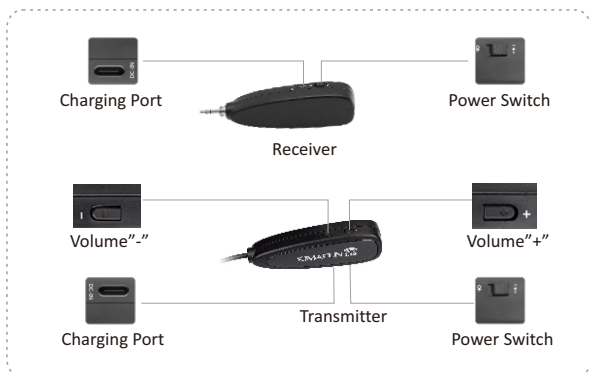

Specification

Connection: Auto-connect

Working Voltage: 5V/1-2A

Power Consumption Current: 0dBm<70mA

Frequency Band: 2.400-2.4835GHz

Wireless Distance: 15 meters (without visible obstacles)

Power Supply: Built-in lithium Battery

Using Time: 5-6 hours

Charging Time: 2 hours

Frequency Response: 20Hz-20KHz

Transmitter Installation

1. Microphone Installation

The microphone is clamped on the edge of the violin and fixed by rotating the lower handle, adjust the hose to make the wheat head reach the best pickup position.



2. Wireless Transmitter Connection

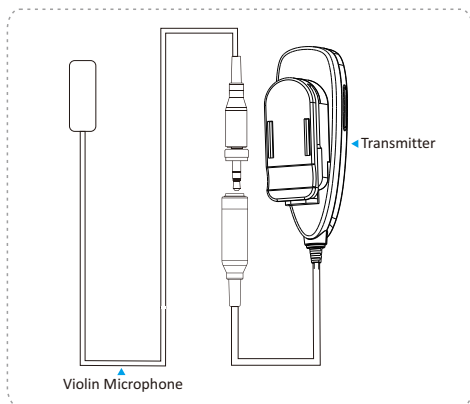

Receiver Installation

1.Mobile Phones and Laptops Connection

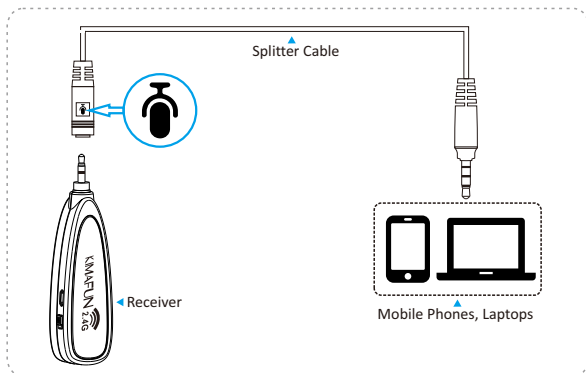

2.Speakers and Mixers Connection

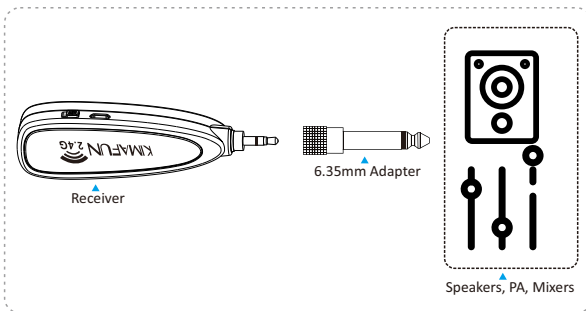

Using Steps

1. Turn on the transmitter and receiver switches, when the indicator lights of transmitter and receiver change from flashing to steady, it means that the pairing is successful.



2.The belt clip is installed on the transmitter, and the transmitter is clamped on the pocket edge or belt (the transmitter should not be covered by clothes) . The microphone is clipped at the neck edge.



3.The receiver is connected with the using device. For out device such as speakers, connect the receiver with 6.35mm adapter, plug them into the MIC input jack of the speakers. For recording device such as mobile phones, laptop, connect the receiver with splitter cable and suitable adapter, then plugged into the recording device.

KM-CX220-2 Package Included



Transmitter with
Microphone



Receiver



USB Charging
Cable



User Manual



Splitter Cable



6.35MM(1/4")
Adapter



Windscreen
Foam



Carrying Bag

KM-CX220-2 Package Included

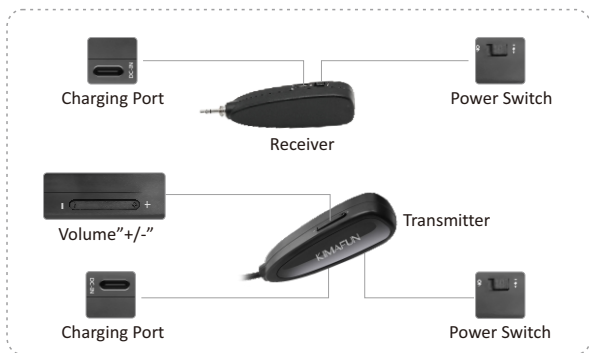

Specification

Mic Capsule: Condenser

Working Voltage: 5V/1-2A

Power Consumption Current: 0dBm<70mA

Frequency Band: 2.400-2.4835GHz

Wireless Distance: 15 meters (without visible obstacles)

Power Supply: Built-in lithium Battery

Using Time: 5-6 hours

Charging Time: 2 hours

Frequency Response: 20Hz-20KHz

Transmitter Installation

The transmitter is clamped on the edge of the violin and fixed by rotating the lower handle, adjust the hose to make the wheat head reach the best pickup position.



Receiver Installation

1. Speakers and Mixers Connection

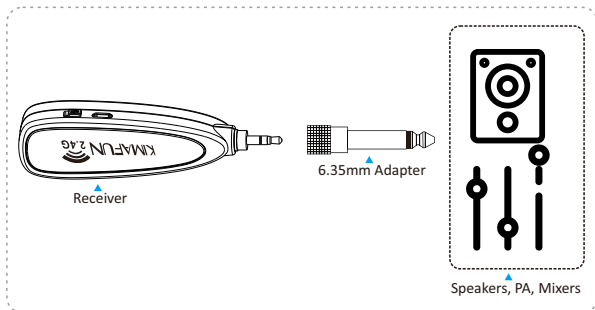

2.Mobile Phones and Laptops Connection

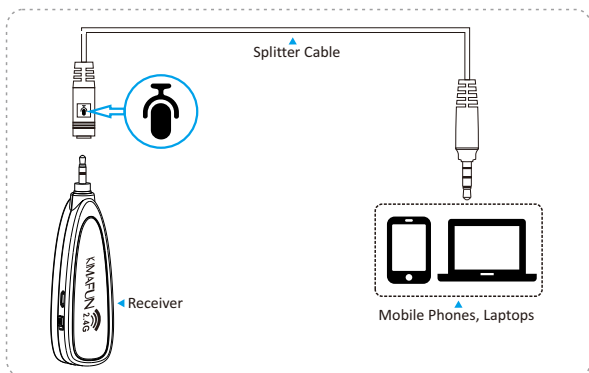

Using Steps

1. Turn on the transmitter and receiver switches, when the indicator lights of transmitter and receiver change from flashing to steady, it means that the pairing is successful.



2. Mount the microphone on the violin strings and adjust to the suitable position.
3. The receiver is connected with the using device.

For out device such as speakers, connect the receiver with 6.35mm adapter, plug them into the MIC input jack of the speakers. For recording device such as mobile phones, laptop, connect the receiver with splitter cable and suitable adapter, then plugged into the recording device.

KM-CX220-3 Package Included



Transmitter with
Microphone



Receiver



6.35MM(1/4")
Adapter



Windscreen Foam



USB Charging
Cable



Splitter Cable



User Manual



Carrying Bag

Main Features

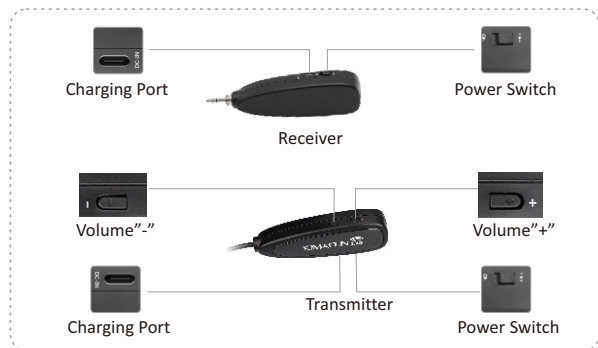

Main Features

Mic Capsule: Condenser

Working Voltage: 5V/1-2A

Power Consumption Current: 0dBm<50mA

Frequency Band: 2.400-2.4835GHz

Wireless Distance: 30 meters (without visible obstacles)

Power Supply: Built-in lithium Battery

Battery: 3.7V/500mA

Using Time: 7-8 hours

Charging Time: 2 hours

Frequency Response: 20Hz-20KHz

Transmitter Installation

The transmitter is clamped on the edge of the violin and fixed by rotating the lower handle, adjust the hose to make the wheat head reach the best pickup position.



Receiver Installation

Speaker/PA/Mixer Connection

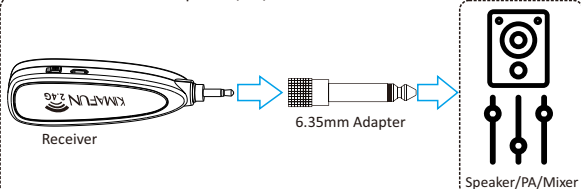

Mobile Phone with Round Hole of Internal Recording Connection

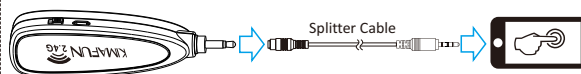

Android Mobile Phone of Internal Recording Connection

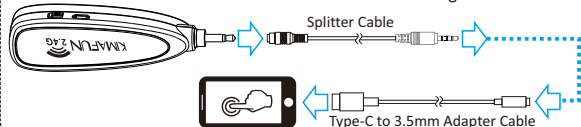

IOS Mobile Phone of Internal Recording Connection

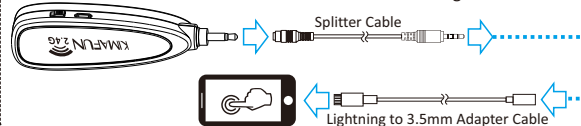

Using Steps

1. Turn on the transmitter and receiver switches, when the indicator lights of transmitter and receiver change from flashing to steady, it means that the pairing is successful.



2. Mount the microphone on the violin strings and adjust to the suitable position.
3. The receiver is connected with the using device.
For out device such as speakers, connect the receiver with 6.35mm adapter, plug them into the MIC input jack of the speakers. For recording device such as mobile phones, laptop, connect the receiver with splitter cable and suitable adapter, then plugged into the recording device.

KM-CX220-4 Package Included



Transmitter with Microphone



Receiver



6.35MM(1/4")
Adapter



Windscreen Foam



USB Charging
Cable



Splitter Cable



User Manual



Carrying Bag

Main Features

Transmitter

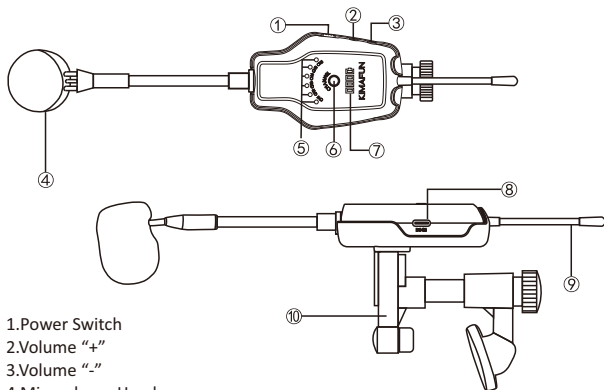

- 1.Power Switch
- 2.Volume "+"
- 3.Volume "-"
- 4.Microphone Head
- 5.Channel Indicator Light
- 6.Channels Switch Button
- 7.Power Display
- 8.Charging Port
- 9.Antenna
- 10.Violin Clip

Receiver

- 1.Power Switch
- 2.3.5mm Plug
- 3.Channel Indicator Light
- 4.Channels Switch Button
- 5.Power Display
- 6.Antenna
- 7.Charging Port

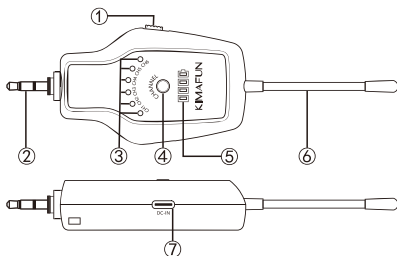

Specification

Transmitter

Frequency Band: 600-928MHz

Frequency Deviation: $\pm 48\text{KHZ}$

Working Current: 110mA

Charging Port: Type-C 5V/2A

Battery: Li-battery 3.7V/800mA

Using Time: 5-6 hours

Charging time: 2 hours

Wireless Distance: 30-50 meters (without visible obstacles)

Receiver

Frequency Band: 600-928MHz

Working Current: 110mA

Charging Port: Type-C 5V/2A

Battery: Li-battery 3.7V/800mA

Using Time: 5-6 hours

Charging time: 2 hours

Microphone

Mic Capsule: Condenser

Polar Patterns: Uni-directional

Mic Diameter: $\phi 14 \times 6.5\text{mm}$

Sensitivity: $-48 \pm 2\text{dB}$

Frequency Response: 20-20KHz

Output Impedance: $\leq 680\Omega$

SNR: $> 63\text{dB}$

Charging Method

Transmitter and receiver of this wireless system are powered by built-in lithium battery. They can be fully charged within 2 hours and be used for 5-6 hours. When power on or charging, the battery indicator light will flash to show the charging progress. After charging is complete, all the battery indicator lights will be stable. Fully charge the transmitter and receiver before use.

Tips:

- 1.The charging interface is a USB Type C port. You can use the charging cable in the package or your own charging cable for charging. It is recommended that you use 5V, 1A-2A charging heads for charging. If you use a laptop or a power bank to charge, it will take longer to fully charge.

2.You can check the current remaining power through the battery indicator. All four indicator lights are on, which means the current remaining power is 100%. Only one indicator lights shows that only a quarter of the battery is left. When the last indicator light flashes, the battery is about to run out, and the device will turn off a few minutes. Please charge it as soon as possible.

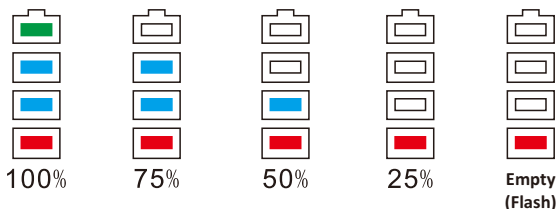

3.Be sure to turn off the power of the device when charging. If the battery indicator and channel indicator are abnormal during charging, please unplug the charging cable and turn off the device to charge again. Please do not use this device while charging.

4.If you do not use this system for a long time, please make sure to charge the device at least once a month to save battery life.

Transmitter Installation

The transmitter is clamped on the edge of the violin and fixed by rotating the lower handle, adjust the hose to make the wheat head reach the best pickup position.

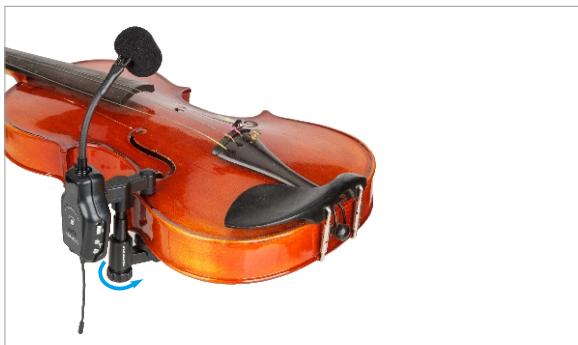

Receiver Installation

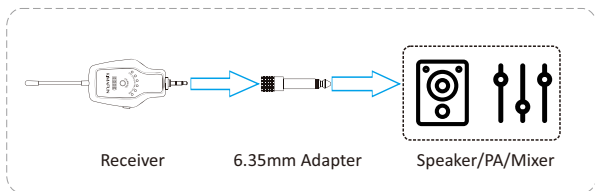

Operating Instructions

1. Switch channel

Turn on the power switch of the transmitter and receiver, push the change channel will switch to the CH1/CH2/CH3/CH4.

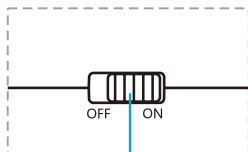

Turn on the power switch

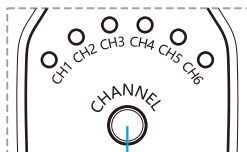

Switch the channel

2. Pairing of transmitter and receiver

The indicator light of any channel of the transmitter and the corresponding channel of the receiver is on for a long time, it means they are in the same channel; If always in flashing, it means they are not in same channel, please take the transmitter and receiver to the closely distance open it again and turn to the same channel. This system supports up to 3 sets of simultaneous use on the same occasion. When using, please pair each transmitter and receiver one by one, and adjust their working channels to 3 different channels.



The indicator light of the same channel is always on (it means that the pairing is successful) .



The receiver and transmitter's indicator light are not in the same channel, and the receiver's indicator light flashes (it means that the pairing is not successful) .

Press the transmitter or receiver channel switch button to switch the transmitter and receiver to the same channel, it means that the pairing is successful.

3.Volume control

There are volume control buttons on the transmitter. Each click on the volume "+" will increase the volume by 2DB. Each click on the volume "-" will decrease the volume by 2DB.

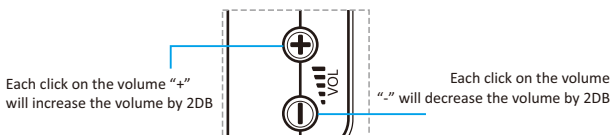

4.Wireless distance

In an open field, the recommended use distance of this system is within 30-50m. If you use this system in strong winds, a site with many obstacles, or a site with strong signal interference around, the available wireless distance may be shortened. No matter how many receivers you use at the same time, please note that the distance between the receiver and the transmitter must be within the allowable use distance. Before the official performance, please use this system to tests the actual distance of the venue.

Troubleshooting

1.How can i used the different working modes of KM-CX220 wired violin microphone?

KM-CX220 has 2 working modes: One is the microphone in the power supply mode, it can be used for speakers, power amplifiers, mixers and other amplification equipment with a 6.35mm MIC Input socket. Other is the microphone not in the power supply mode, it can be used for mobile phones and single-hole laptops.

2.Why there is small sound and no sound suddenly when using this product?

- 1) About KM-CX220, when microphone in the power supply mode, please turn the switch to OFF/PHONE if the mic isn't using. Otherwise, the battery will still be in working condition, cause the power electricity loss. Please replace the battery of the same model (LR626).
- 2) About other models, please check the battery power of the product. If the battery power of the device is too low, it cannot be used. Please charge it as soon as possible.
- 3) Please check if there is strong WIFI signal interference around the transmitter.

3.Why this product can not use my Android Type-C port smartphone?

If your Android smartphone are Type-C port, it need to use the Type-C to 3.5mm adapter; Insert the transmitter into the splitter cable, splitter cable connect with your own Type-C to 3.5mm adapter, and plugged it into your Type-C port smartphone.

4.Why this product can not use my IOS smartphone?

For iPhone 7 or above smartphone, it need to use the lightning to 3.5mm adapter; Insert the transmitter into the splitter cable, splitter cable connect with your own lightning to 3.5mm adapter, and plugged it into your IOS smartphone.

5.Why can't i hear any sound when i use this product?

- 1) Please check the battery power of the product. If the battery power of the device is too low, it cannot be used.
- 2) Please check the matching status of the transmitter and receiver, whether the matching is successful, and whether the connection is lost due to exceeding the usable wireless distance
- 3) If you using on the mobile phone, make sure that you already use the splitter cable. If the recording is silent, please confirm that if you are using the third-party video or audio software (teaching video, Tik Tok etc;) For Apple mobile phone can use Apple's own video or audio software). After recording, please remove the splitter cable from the mobile phone.
- 4) Please check if the speaker is working and if there is any sound playing.
- 5) Please adjust the volume on the receiver or volume of the mobile phone, speaker etc device.
- 6) Please make sure there is not metal objects or other objects block the transmitter and receiver, to prevent frequency interruption or affect the use distance.

6. Why i hear low voice when i use this product?

- 1) If the distance between installation of microphone and strings is too far. Please try to adjust the distance of microphone and angle of microphone head.
- 2) Please adjust the volume on the receiver or volume of the mobile phone, speaker etc device.
- 3) Low wattage of equipment (lower than 100 watt), such as AUX input's Bluetooth small audio.

7.Why i hear noise sound when i use this product?

If there is a strong magnetic field or acoustic radio interference.

8.Why i hear squeal sound when i use this product?

- 1) Please keep the transmitter not facing speaker and not in a short distance, such as keep 2-3 meters distance, and the speaker not close to the wall. Turn down the volume of the transmitter and turn down the volume of the speaker or mobile phone etc device.
- 2) Please do not turn on the speaker loudly in the close or narrow space. This device is not suitable for small power amplifiers. Please insert the "MIC" jack when use the loudspeaker, rather than "AUX" jack.

9.Why only one red indicator light is flashing when using this product for several hours?

When the last indicator light flashes, the battery is about to run out, and the transmitter or receiver will turn off in a few minutes. Please charge it as soon as possible.

Shenzhen JHC Electronics Co.,Ltd
Email For Customer: info@kimafun.com